

Six-Pac®

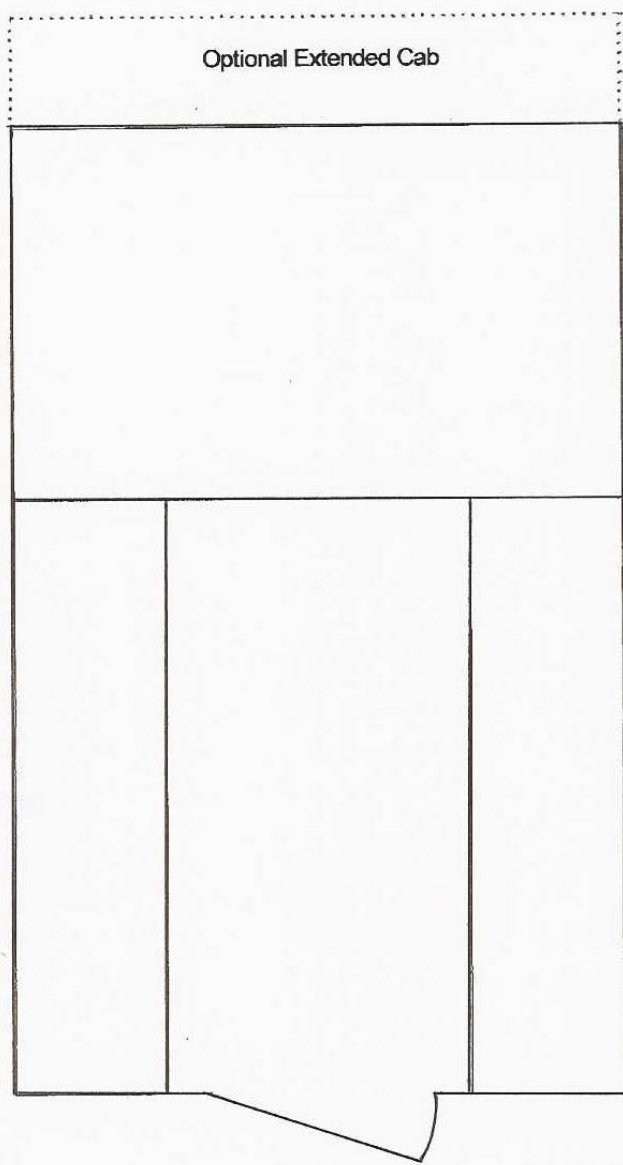

Utility Model (Shell) Sizes Available For Most Trucks

Overall Length (Nose to Ladder)	varies	Floor Length	varies
Overall Width (Jack to Jack)	varies	Body Width	varies
Overall Height (Floor to Top of Ladder)	varies	Average Dry Weight	varies



The **Six-Pac Utility** is a spacious, versatile “working camper”, designed to earn its keep on any make, model or size truck.

The Utility has a sleek, open interior, unencumbered by a galley, refrigerator or closets, and is ideal for transporting anything from tools to toys to tack. And the Utility’s lightweight classification makes this a camper you can handle... both on the road and at the fuel pump.

No matter where your adventures take you, you’ll be glad you’re making the trip in a Six-Pac.



Six-Pac®

Standard Features:



Completed Shell, Fully Insulated
Queen Cabover Bed w/ Mattress
Basement Storage
4 windows (2 OH sides, large passenger side, rear wall)
Escape Hatch w/ Screen & Rear Ladder
Center Roof Vent (pre-framed for second)
Overhead Storage Shelf Both Sides
24" Entry Door w/ Screen & Window
4 Interior Lights
Rear Porch Light
Linoleum Flooring
Front Sliding Window
4 corner "jack brackets only"
Diamond Plate Lower / Exterior Base
No water system
No 120V electrical system
No converter/battery charger
No refrigerator

Available Options:

Single or Double Sofas (converts to bed)
Single or Double Fold Down Bunk
Large Drivers Side Window
Coleman PolarClub Air Conditioner
Fantastic Power Roof Vent Fan
Forced Air Furnace w/ Battery Box (no battery)
Perimeter Roof Rack
Mechanical Camper Jacks
Cabover Front Window
8' Side Awning
Porta Potti
Rear Flood Lights
Folding Entry Step (aluminum — accordion)
Aux. Camper Battery System
Extended Cabover Bed (85" x 80" King bed)
Overhead Storage for Extended Cabover Bed
12 volt Accessory Outlet
Extra Roof Vent
Passenger or Drivers Side Wing Cushion
Pleated Window Shades
Single 12v Deep Cycle Battery



Northern California Factory & Showroom
1460 Churchill Downs Ave., Woodland, CA 95776
(800) 242-1442 or (530) 666-1442 WWW.SIX-PAC.COM